



PMP-50GPD

BOOSTER PUMP



PMP-50GPD SPECIFICATIONS

MODEL NUMBER:	PMP-50GPD
PUMP DESIGN:	Positive displacement
DIAPHRAGM PUMP:	Three chamber
MOTOR:	Permanent magnet
VOLTAGE:	24 VDC
PRESSURE SWITCH:	None
LIQUID TEMPERATURE:	140° F (60° C) max.
PRIME:	Self-priming 1 meter
RUNS DRY:	WITHOUT DAMAGE
PORTS:	3/8"-18 NPT female
NET WEIGHT:	Plastic plate 3.76 lbs (1.70 kg) Iron plate 3.92 lbs (1.78 kg)
DUTY CYCLE:	Continuous
TYPICAL APPLICATIONS:	R.O. booster pump and water delivery
BYPASS:	120 psi

INLET - 8 PSI		
PRESSURE (PSI)	FLOW GPM / (L/min)	CURRENT (AMPS)
Open Flow	0.33 / 1.26	0.15
10	0.32 / 1.21	0.19
20	0.3 / 1.12	0.26
30	0.27 / 1.04	0.33
40	0.26 / 0.97	0.40
50	0.23 / 0.88	0.49
60	0.21 / 0.78	0.56
70	0.18 / 0.69	0.62
80	0.16 / 0.60	0.68
90	0.12 / 0.44	0.73
100	0.042 / 0.16	0.76
120	BY PASS	0.82

All data based on testing with water | Voltage (Volts): 24 VDC/1.2A/Adaptor

NOTE: Performance will vary with variation in service voltage and transformer output

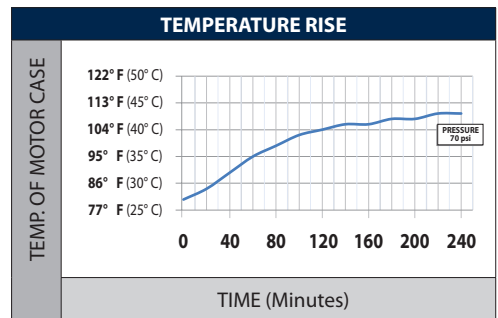
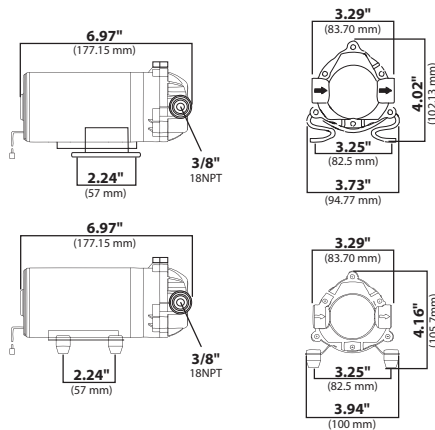

THIS TEST IS BASED ON RUNNING CONTINUOUSLY WITH AN AMBIENT TEMPERATURE OF 78.8°F (26°C) IN STILL AIR

LIT-PMP-50GPD-DS 10/15/18



AQUATROL | P.O. Box 2235 Chino Hills, CA 91709 • USA

Distributed by:

WWW.AQUATROLTECH.COM